

# Transforming Twickenham Station

For the next stage of works on the new Twickenham Station access to the footbridge and platforms will be changing from Monday 15th October 2018.

From the morning on Monday 15th October 2018 you will need to turn **RIGHT** rather than left to reach the footbridge for access to platforms 4 and 5.

Access to the station and ticket office, via the current entrance at the side of Platform 3, will remain unchanged. Disabled access to the station will also be unaffected.

The changes will not impact on how long it takes for passengers to reach platform level and clear signage will be in place to indicate the new route to the footbridge and platforms.

The new route is highlighted on the updated diagram.

If you would like any more information on the ongoing works at Twickenham Gateway visit [www.twickenhamforward.com](http://www.twickenhamforward.com)

The Community Liaison Officer is Rowan Cole. If you would like to get in contact with Rowan please email him at [community@twickenhamforward.com](mailto:community@twickenhamforward.com)

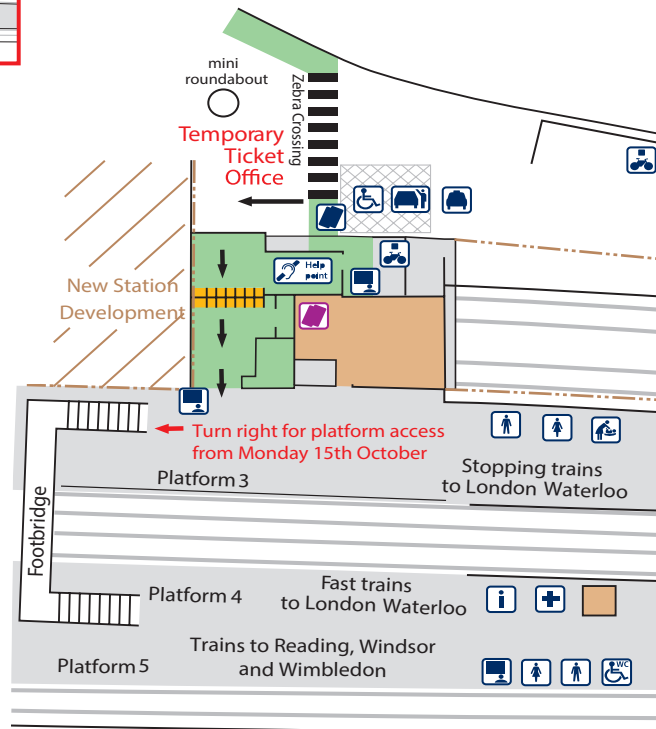
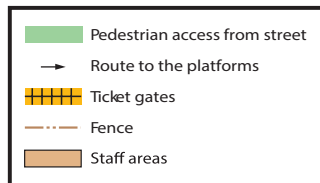
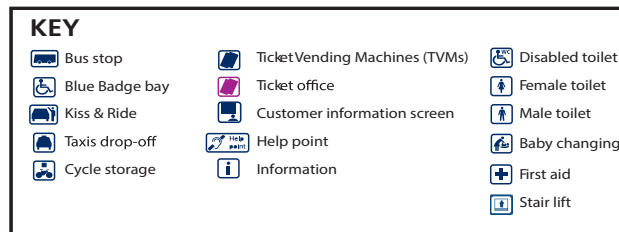
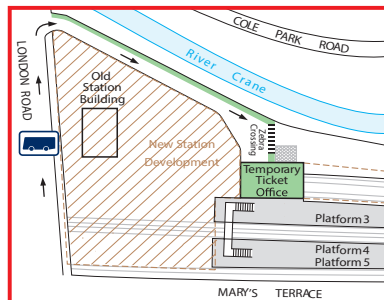

# Solum

Where Life Meets